

October 2013
Block of the Month
Foundation Tree and Log Cabin
 Finished size: 10" x 10" Unfinished: 10 1/2" x 10 1/2"
 Adapted from December 2001 BOM Archive

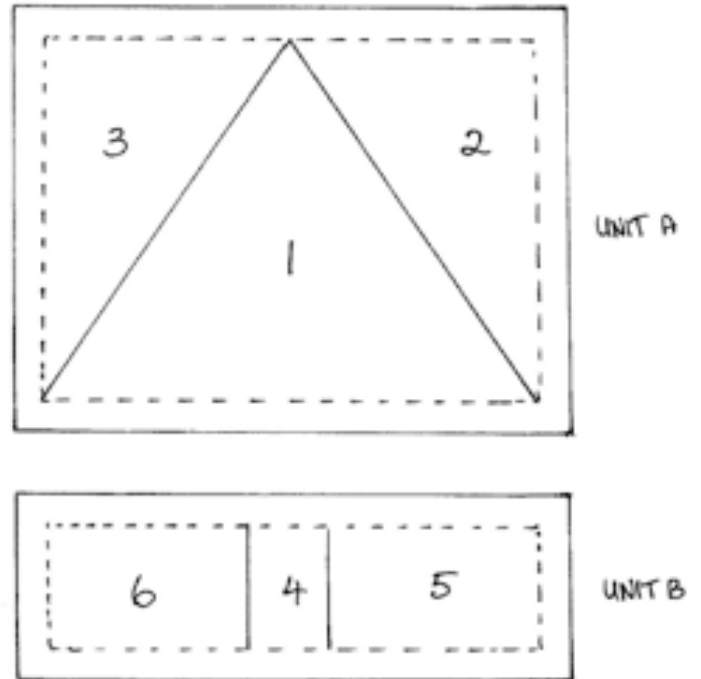

FABRICS and METHOD:

Tree Centre:

- Dark green 1
- Brown Trunk 4
- Light blue background 2,3,5,6

Foundation piece the tree centre.

Note: Unit A is sewn to Unit B.

Unfinished Size: 4 1/2"

Finished Block size: 4"
 Unfinished Block size: 4 1/2"

Log Cabin:

Cut strips 1 1/2" wide

- 3 rows of light cream
- 3 rows of dark brown

Starting with light, sew log cabin strips clockwise around the tree centre.

Press away from the centre.

Unfinished Block size: 10 1/2" x 10 1/2"

